

---

# Flying Fish Swim School

Resuming Operations Strategic Plan

---



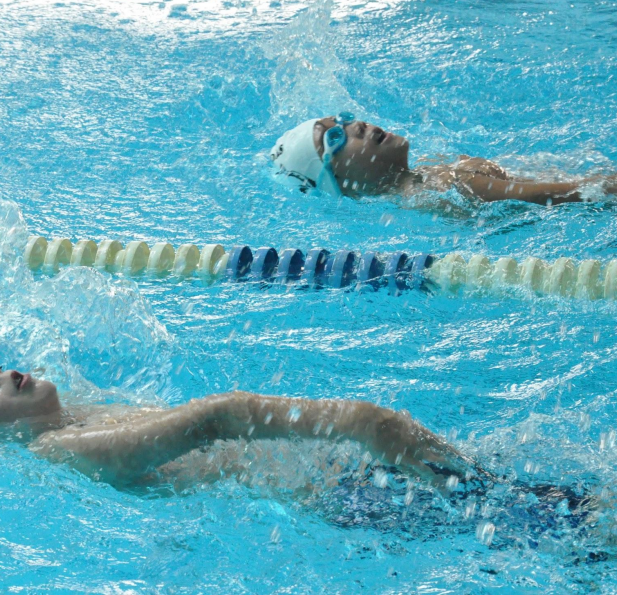

## Message

Dear Members,

We hope that you and your loved ones have stayed safe during this time. We are preparing and looking to reopen our facilities when it is safe to do so. We are continuing to monitor COVID-19 and are mirroring our policies based on the recommendations by the Center for Disease Control and Prevention (CDC) and are working closely with local health officials. The health and safety of our staff and members is our highest priority.

# Protocols Implemented For Reopening

01. **Facility Protocols**
02. **Staff Protocols**
03. **Student Protocols**
04. **Family Guardian Cooperation Protocol**
05. **Road Map**



# Facility Protocols

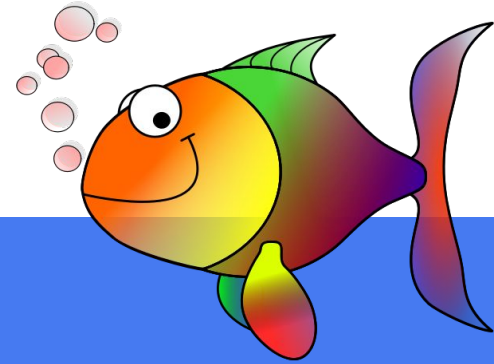

- One way doors used to exit and enter the building.
- Floor markers used to guide one way traffic as well as enforce social distancing.
- Changing stalls to enforce social distancing.
- Hand sanitizer provided throughout the building.
- Locker rooms will remain available for basic restroom needs but with the installation of changing stalls located on the outside of the bathroom, we encourage their minimalized use.

# Facility Protocols- Sanitation Schedule

**Hourly**

Pool chemical check- hourly.

Sanitation of frequent touch surfaces.

Automatic toilet bowl cleaner installed in toilet.

**Hourly**

Pool deck and chairs cleaned and disinfected hourly.

Changing rooms, doors and anything else that is touched.

Front desk will be disinfected hourly.

## Staff Protocols

- Prior to entering the facility, staff will have their temperature checked.
- All staff will be required to wear PPE throughout their shift and time in the facility.
- Frequent handwashing will be enforced.
- All staff will be trained on protocols making them capable of executing proper social distancing and sanitation.
- Plexiglass will be placed in front of the front desk for added protection for staff as well as members.



## Student Protocol

- Before coming to class the swimmer is expected to have their temperature checked at home.
- If the student feels sick or has any symptoms, please stay home.



## Family Guardian Cooperation Protocol

- Due to the limited seating due in part from the social distancing requirement, please limit one guardian coming into the facility.
- Wear face masks and stay in designated areas.
- Temperature and symptom checking before class.





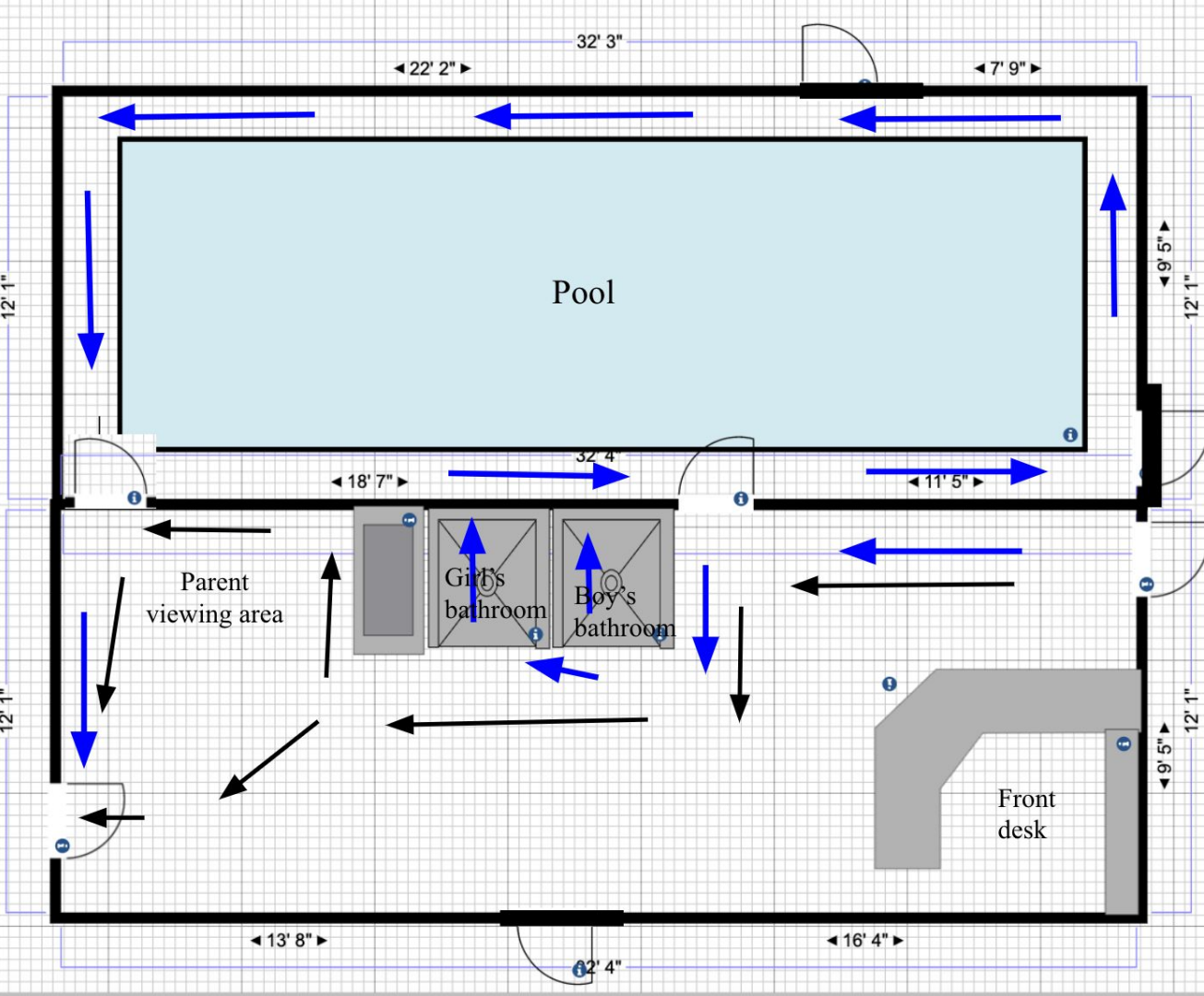

Blue arrows= for students

Black arrows= for parents and guardians